

Exploded Views Model:PL115i

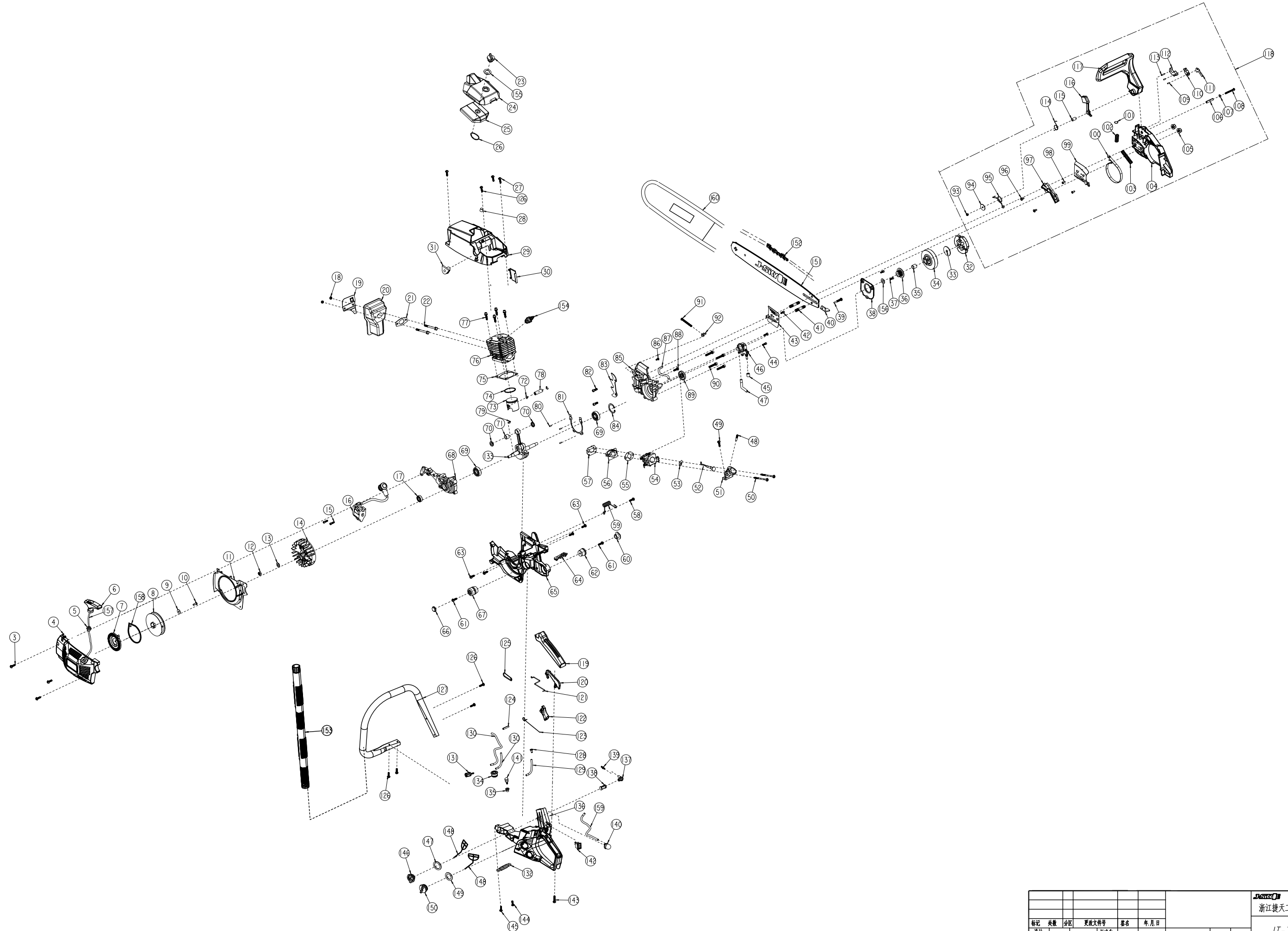

					浙江捷天工贸有限公司	
					JT-YD38油锯	
标记	数量	分区	更改文件号	签名	年月日	
设计			标准化			
校对						
审核						
工艺			批准			
					共张	第张

No.	Part num	Description(Cn)	Description(En)	Qua.
3	5249900501	梅花一字盘头自攻螺钉9.4mm\ST5X16	Screw ST5X16	3
4	5010108101	38普通款启动器罩	Starter Cover	1
5	5010207701	YD45油锯过绳套\胶木	Sleeve	1
6	5010100801	启动手柄	Starter handle	1
7	5140100601	45\52启动器盘簧	Rewind Spring	1
8	5010106701	38普通款绳轮	Pulley	1
9	5260101001	平垫片\5x16x1	Washer	1
10	5240300101	十字盘头自攻螺钉	Screw ST5X12	1
11	5010103201	38导流罩	Air Fairing	1
12	5250500501	六角螺母	Nut/M8X6	1
13	5260100501	平垫片\8x16x1	Washer	1
14	4010400201	38飞轮	Fly wheel	1
15	5230201101	内六角圆柱头螺钉8.8级	Screw /M4X14	2
16	5810100201	38高压包	38Ignition module	1
17	5110101001	油封\曲轴箱密封12x22x7	Oil seal	1
18	5250300401	尼龙防松螺母	Nut/M5	2
19	5150101601	38消音器压板	38 Muffler plate	1
20	4020100201	38消音器	38Muffler	1
21	5870100201	38消音器隔热垫片	Muffler Washer	1
22	5239900301	方头专用螺栓\有效螺纹长度大于15	Screw / M5X60	2
23	5010104201	38\45\52小盖旋钮	Air filter cover Nut	1
24	5010104101	38小盖	38 Air Filter Cover	1
25	5010104001	38空滤器	38 Air filter	1
26	5110100701	38空滤器垫圈	38 Air Filter Gasket	1
27	5249900501	梅花一字盘头自攻螺钉	Screw/ST5X16	3
28	5110105201	38空滤器减震	Air Filter Anti Vib	1
29	5010105501	38大盖	38 Top Cover	1
30	5010103401	38防冻板	38 Stop Wind Plate	1
31	5010103501	38怠速调节套	Car. Adjustment Sleeve	1
32	4030102301	38油锯离合器总成	38Clutch	1
33	5260100701	38离合器减磨垫	Steel Washer	1
34	5150102601	38油锯被劝盘	Clutch hup	1
35	5300301801	滚针轴承\K101313	Needle Bearing	1
36	5010105901	38涡轮	38Warm	1
37	5230200301	内六角圆柱头螺钉	Screw M4X10	2
38	5010105801	38机油泵盖板	Oil Pump Cover	1
39	5239902601	内梅花一字盘头螺钉	Screw M5X32	1
40	5150101701	38挡链块	Chain Cacher	1
41	5239900501	等长双头螺栓	Screw M8X42	2
42	5230200301	内六角圆柱头螺钉	Screw M4X10	1
43	5150102301	38喷油嘴盖板	Cover	1
44	5230200101	内六角圆柱头螺钉	Screw M4X12	2
45	5120101001	38\机油泵防尘滤棉	Oil Pump Filter Sponge	1
46	4010300101	38机油泵	Oil Pump	1
47	5110101901	38机油管	Oil Pipe	1
48	5239900401	38进气弯管螺柱	Screw M5x24mm	1

No.	Part num	Description(Cn)	Description(En)	Qua.
49	5249900501	梅花一字盘头自攻螺钉9.4mm\ST5X16	Screw ST5X16	1
50	5239902501	内梅花一字盘头螺钉	Screw M4X70	2
51	5010105701	38进气弯管	Intake Holder	1
52	5010217401	38风门拉杆	Choke Rod	1
53	5010103901	38风门杆座	Choke Rod Mount	1
54	4030205401	38化油器(金属联动)	Carburetor	1
55	5860100901	38化油器密封垫片	Car. Gasket	1
56	5010211101	38进气管	Intake Valve	1
57	5860100801	38进气管密封垫片\厚度0.9	Intake Inlet Gasket	1
58	5249900701	梅花一字盘头自攻螺钉	Screw ST5X14	1
59	5130100401	38提把扭簧	Handle AV Spring	1
60	5010103001	38大防尘盖	AV Cover	1
61	5249900501	梅花一字盘头自攻螺钉	Screw ST5X16	2
62	5110101201	38箱体短减震	Anti Vib Rubber	1
63	5239902701	内梅花一字盘头螺钉	Screw M5X14	4
64	5010102701	38油门推杆座\TPU95度	Car. Rod Mount	1
65	5010107601	38箱体底座	Crank Case Mount	1
66	5010103101	38小防尘盖	AV cover	1
67	5110101101	38箱体长减震	Crank case AV Rubber	1
68	5180100401	38左曲轴箱	Left Crank case	1
69	5300100201	6201深沟球轴承	6201 bearing C grade 12x32x10	2
70	5339900501	38减磨垫\10x17x3	Piston Needle Washer	2
71	5300300101	滚针轴承\K101411	Needle Bearing	1
72	5275100201	38活塞销卡簧	Piston Criclip	2
73	5180300101	38活塞	Piston	1
74	5330100201	38活塞环	Piston Ring	1
75	5860100701	38气缸密封垫片	Cylinder Gasket	1
76	5180200201	38气缸	Cylinder	1
77	5230502401	内六角圆柱头组合螺钉\8.8级	Screw M5x20	4
78	5290100801	38活塞销\10x6x32	Piston Pin	1
79	5290200301	半圆键	Key	1
80	5290101001	圆柱销	PinØ3X8	3
81	5860100601	38箱体密封垫片	Crank Case Gasket	1
82	5230600901	内六角圆柱头螺钉	Screw M5x14	2
83	5150105501	插木齿	Felling Dog	1
84	5285100801	孔卡\孔径32	Hole Circlip	1
85	5180100501	38右曲轴箱	Right Crank Case	1
86	5010107301	38喷油嘴	Sleeve	1
87	5110101901	38机油管	Oil Pipe	1
88	5249900501	梅花一字盘头自攻螺钉	Screw ST5X16	1
89	5110100901	油封\曲轴箱密封32x12x5.5	Oil Seal	1
90	5230502901	内六角圆柱头组合螺钉\8.8级	Screw M5X30	4
91	5230700401	十字一字盘头组合螺钉	Screw M5X50	1
92	5150102201	38涨紧器块	Tensioner Block	1
93	5259900201	尼龙防松螺母	Nut M4	1
94	5260100901	38刹车板销垫片	Washer 5x23x1	1

